





COMMUNE DE CLOS DU DOUBS

MONTMELON 1:2'000

PROVISOIRE

AMENAGEMENT LOCAL

Plan des modifications du plan de zones

-  Contour de la zone à bâtir actuelle
-  Extension de la zone à bâtir
-  Modification du genre de la zone à bâtir
-  Restitution à la zone agricole



04.11.2022 / MAO

Montmelon village - 1:2000

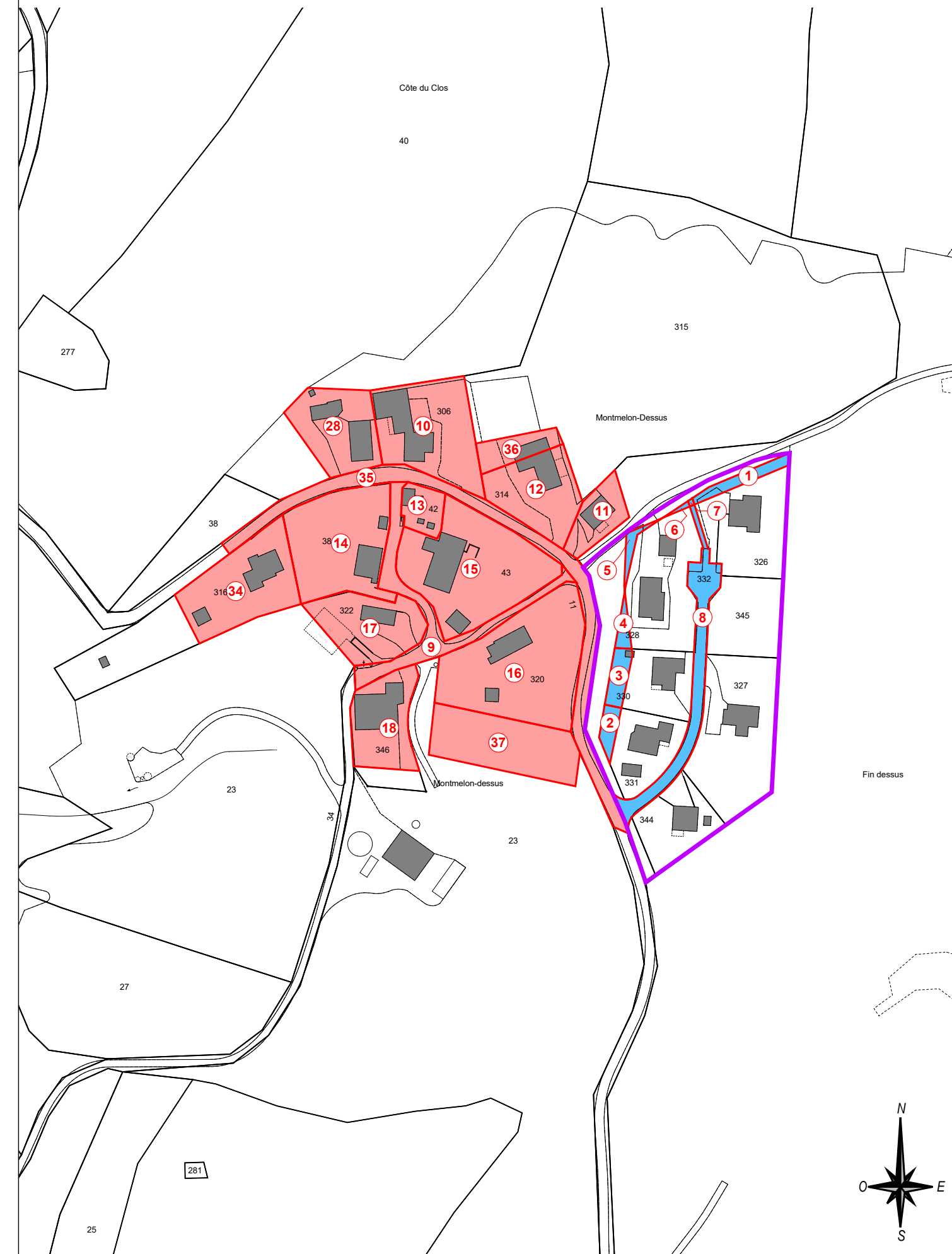

Montmelon camping - 1:2000

